



ALUBASTER DIRECT Surface datasheet



Project: Private Residence | Architect: Orea

The Alubaster Direct collection by ONE A is a modular system, which can be assembled in various constellations.

The collection consists of three main components, respectively in aluminium and alabaster, available in different lengths.

GENERAL DATA

Collection

ONE A

Product

Alabaster Direct – surface

Article no.

- 1A13.5592.xx65
(Tube 300/120, Alabaster 120)
- 1A13.5593.xx65
(Tube 300/120, Alabaster 210)
- 1A13.5594.xx65
(Tube 300/120, Alabaster 300)
- 1A13.5692.xx65
(Tube 300/300, Alabaster 120)
- 1A13.5693.xx65
(Tube 300/300, Alabaster 210)
- 1A13.5694.xx65
(Tube 300/300, Alabaster 300)

SPECIFICATIONS

Weight

1.935 kg / 3 kg (alu)

3.39 kg / 5.12 kg (brass)

Material

Aluminium / Brass
and Alabaster

IP protection grade

IP20

Labelling

CE

TUBE



ALABASTER

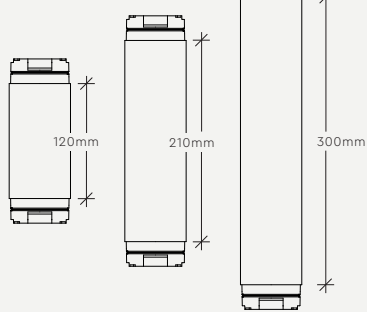

TUBE - with downlight

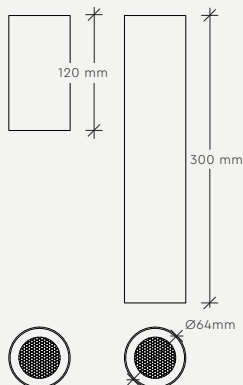

MAINS POWERED – ELECTRICAL SPECIFICATION

1A13.5X9X.xx65 – 230V

Supply	14W AC200-240V 50/60Hz
CCT	2500K (nature stone – variations will occur!)
Lumen	100-200 lm
Efficiency	35-40 lm/W
CRI	90+
Insulation class	Class II
Dimmable	Triac dimmable



Dimmer	Driver code	A		B			C			D		E		F		G						
		VADSBO		NIKO			BUSCH			OPUS		OPUS		OPUS								
		Result	P _{max}	P _{min}	Result	P _{max}	P _{min}	Result	P _{max}	P _{min}	Result	P _{max}	P _{min}	Result	P _{max}	P _{min}						
IAL. 19.27.15	200V	5.121	0.512	✓	4.993	0.853	✓	5.207	turn off	✓	5.207	0.853	✓	5.164	0.725	✓	5.249	0.64	✓	5.292	2.006	
	240V	small flash at the low point	5.804	0.768	✓	6.103	1.835	✓	6.316	turn off	✓	6.7	1.237	✓	6.658	1.067	✓	6.572	0.939	small flash at the high point	5.633	2.859
	264V	5.804	0.939	✓	6.487	3.414	✓	6.487	0.811	✓	6.828	1.494	✓	6.786	1.28	✓	6.7	1.109	small flash at the high point	5.761	3.414	

XX – COLOUR CODES

	01 – white		33 – nature*
	92 – black pearl		34 – antique*
	53 – elephant grey		35 – night*
	97 – gold		
	98 – silver		
	99 – bronze		



COMPONENTS

- Alabaster Direct
- light source
- allen key

IMPORTANT INFORMATION

Installation and mounting must be performed by a certified electrician only, and instructions must be followed. Always make sure the main power is off during installation. Pay attention to the fixture remarks, and always make sure to use the correct voltage.

CLEANING AND MAINTENANCE:

Use a soft moist cloth for cleaning. No further maintenance is required.

WARRANTY:

If the product is defect, please contact your supplier immediately. Please note that warranty will not apply in case of wrongful use or if unskilled personnel attempts to repair.



The crossed-out wheeled bin symbol indicates that the item should be disposed of separately from household waste. The item should be handed in for recycling in accordance with local environmental regulations for waste disposal

For more information, please contact info@onea.dk

ASSEMBLY INSTRUCTION

Page 1 of 3

STEP 1

Mount the fixture onto the ceiling, by placing the Base over the screws and slightly rotating, then tighten the screws.

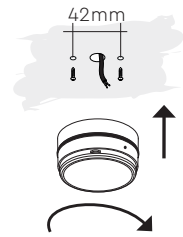

STEP 2

Connect the wires.

BE ATTENTIVE! Make sure you have connected the power correctly, please refer to Storm Output assembly instructions or other outlet

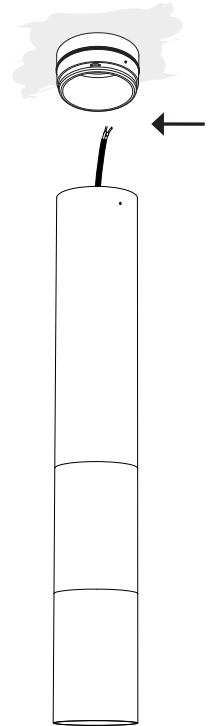
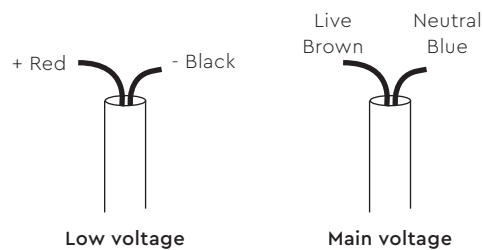

STEP 3

Mount the Tube onto the Base, by gently rotating until the allen screw aligns with the hole in the tube.

To secure the tube in place, turn the allen screw anti-clockwise until the screw is flush with the tube.

NOTE: When rotating the fixture choose the direction with the least resistance.

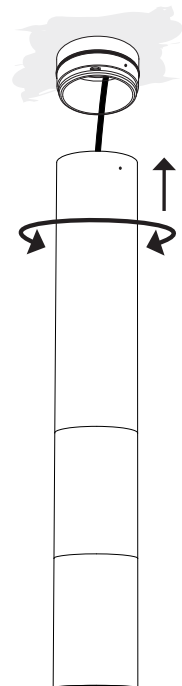

ASSEMBLY INSTRUCTION

Page 2 of 3

INSTRUCTIONS TO CHANGE LIGHT SOURCE

STEP 1

To remove Alabaster Part:

1. With the accompanying allen key turn the screw clockwise until the Alabaster part can rotate
2. Take hold of the Alabaster part, then gently pull down, whilst slightly rotating

NOTE: When rotating the fixture choose the direction with the least resistance.

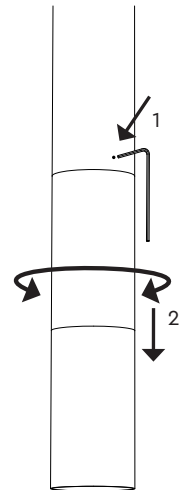

STEP 2

1. Turn the 3 screws anti-clockwise using the allen key.
2. Remove the retaining ring using light pressure.

Then replace the light source, reattach the retaining ring, make sure it snaps. Finally, fasten the 3 screws, so that they are flush with the fixture ring.

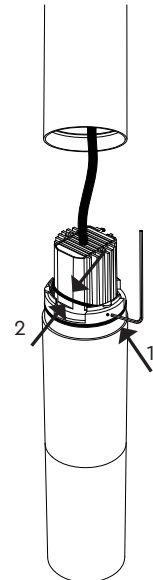

STEP 3

1. Remount the Alabaster part in the Tube, by gently rotating until the allen screw aligns with the hole in the Tube.
2. Secure the Alabaster part in place by turning the screw anti-clockwise until the screw is flush with the tube.

NOTE: When rotating the fixture choose the direction with the least resistance.

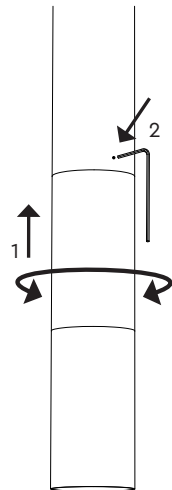

IMPORTANT INFORMATION

Installation and mounting must be performed by a certified electrician only, and instructions must be followed. Always make sure the main power is off during installation. Pay attention to the fixture remarks, and always make sure to use the correct voltage.

CLEANING AND MAINTENANCE:

Use a soft moist cloth for cleaning. No further maintenance is required.

WARRANTY:

If the product is defect, please contact your supplier immediately. Please note that warranty will not apply in case of wrongful use or if unskilled personnel attempts to repair.



The crossed-out wheeled bin symbol indicates that the item should be disposed of separately from household waste. The item should be handed in for recycling in accordance with local environmental regulations for waste disposal

For more information, please contact info@onea.dk

ASSEMBLY INSTRUCTION

Page 3 of 3

STEP 4

Lightly push in the honeycomb, thereby creating space to take hold of the Direct fixturing, then gently pull down.

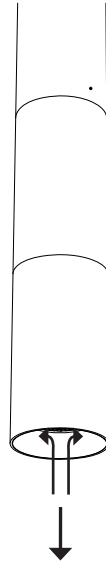

STEP 5

Remove the retaining ring using light pressure and replace the light source. Reattach the retaining ring, make sure it snaps. Then remount the Direct in the Tube, by slightly rotating the Direct into place.

NOTE: When rotating the fixture choose the direction with the least resistance.

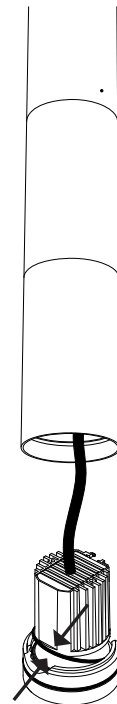

IMPORTANT INFORMATION

Installation and mounting must be performed by a certified electrician only, and instructions must be followed. Always make sure the main power is off during installation. Pay attention to the fixture remarks, and always make sure to use the correct voltage.

CLEANING AND MAINTENANCE:

Use a soft moist cloth for cleaning. No further maintenance is required.

WARRANTY:

If the product is defect, please contact your supplier immediately. Please note that warranty will not apply in case of wrongful use or if unskilled personnel attempts to repair.



The crossed-out wheeled bin symbol indicates that the item should be disposed of separately from household waste. The item should be handed in for recycling in accordance with local environmental regulations for waste disposal.

For more information, please contact info@onea.dk

DISASSEMBLY INSTRUCTION

STEP 1

To dismount:

1. Turn the screw clockwise with the accompanying allen key, until the tube is able to rotate.
2. Then gently pull down on the Tube, whilst slightly rotating.

NOTE: When rotating the fixture choose the direction with the least resistance.

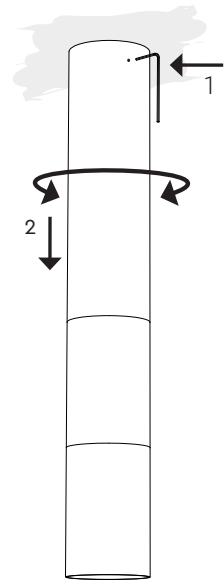

STEP 2

Disconnect the wires.

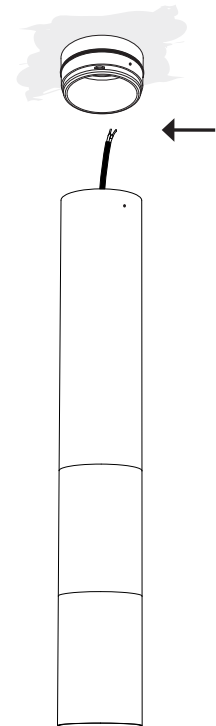

STEP 3

Loosen the screws, then slightly rotate and gently pull down.

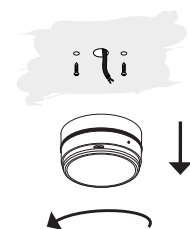

IMPORTANT INFORMATION

Installation and mounting must be performed by a certified electrician only, and instructions must be followed. Always make sure the main power is off during installation. Pay attention to the fixture remarks, and always make sure to use the correct voltage.

CLEANING AND MAINTENANCE:

Use a soft moist cloth for cleaning. No further maintenance is required.

WARRANTY:

If the product is defect, please contact your supplier immediately. Please note that warranty will not apply in case of wrongful use or if unskilled personnel attempts to repair.



The crossed-out wheeled bin symbol indicates that the item should be disposed of separately from household waste. The item should be handed in for recycling in accordance with local environmental regulations for waste disposal

For more information, please contact info@onea.dk