

STORM MEDIUM MOTION

DATA

Collection	STORM SYSTEM®
Product	Storm Medium Motion
Article no.	1A01.0201.xx

SPECIFICATIONS

Weight	250 g
Materials	Aluminium and polycarbonate
IP protection grade	IP20
Fixture finish	For xx-codes review STORM SYSTEM® – COLOUR CODES >

ADDITIONAL REQUIREMENTS

MOTION DETECTORS

Master units

- Motion Kit KNX Multi Detector >
– 1AK.0201.xx20
- Motion Kit KNX Space Detector >
– 1AK.0201.xx21

Slave units – Optional (only functional in combination with KNX Master unit)

- Motion Kit Slave Sensor CO2 + Temperature >
– 1AK.0201.xx22
- Motion Kit Slave Sensor VOC + Temperature >
– 1AK.0201.xx23



STORM SYSTEM®

The Storm Medium Motion is part of the STORM SYSTEM® MEDIUM collection. A collection that includes a wide range of special designed products. The STORM SYSTEM® collection is carefully designed to flush the surface of any ceiling or wall, and all products will appear with an absolute minimum of tolerance and visibility.

Storm Medium Motion is a fixture which in combination with a Motion Kit will provide a motion detector. Available sensors; KNX

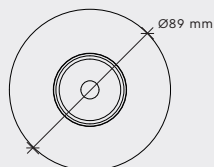
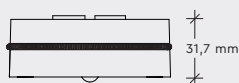

IMPORTANT INFORMATION

Installation and mounting must be performed by skilled personnel only, and instructions must be followed.

CLEANING AND MAINTENANCE:

Use a soft moist cloth for cleaning. No further maintenance is required.

WARRANTY:

If the product is defect, please contact your supplier immediately. Please note that warranty will not apply in case of wrongful use or if unskilled personnel attempts to repair.

COMPONENTS

- Storm Medium Motion
- Retaining disk
- Spring

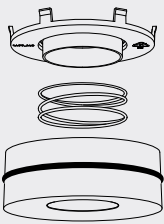

- Motion Kit (sold separately)

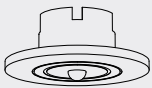

PLEASE NOTE:

If the spring on the fixture is damaged, do not proceed installation – contact your dealer!

STORM MEDIUM MOTION

ASSEMBLY INSTRUCTION

STEP 1

Place the chosen Motion Kit in the fixture ring. Place the spring and retaining disk over the Motion Kit

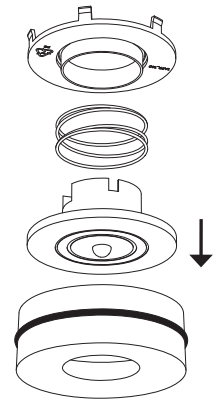

STEP 2

Gently press the retaining disk down until it snaps into place

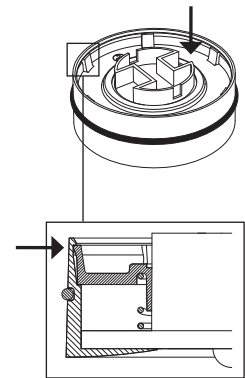

STEP 3

Connect the supply cable.

Mount the fixture into the plaster ring/
back-mounted ring.
Do this by slightly rotating the fixture
into the plaster ring/back-mounted ring.

NOTE: When rotating the fixture
choose the direction with the least
resistance.

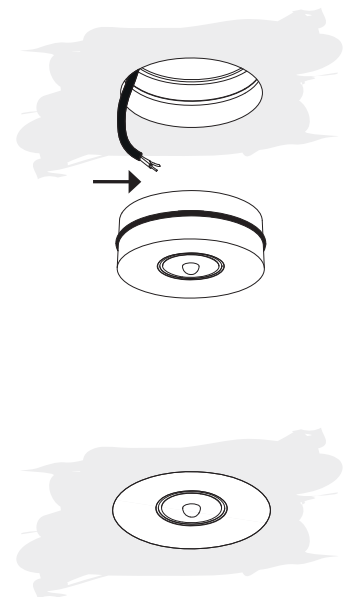

IMPORTANT INFORMATION

Disassembly must be performed by skilled personnel only, and instructions must be followed.

WARRANTY:

If the product is defect, please contact your supplier immediately. Please note that warranty will not apply in case of wrongful use or if unskilled personnel attempts to repair.

STORM MEDIUM MOTION

DISASSEMBLY INSTRUCTION

STEP 1

Lightly push in the center, thereby creating space to take hold of the fixture.

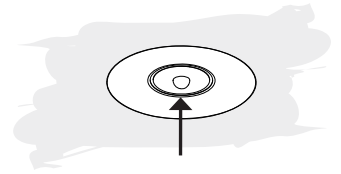

STEP 2

Take hold of the fixture.

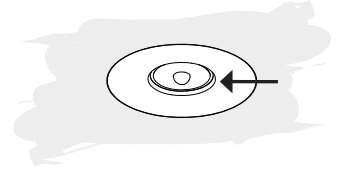

STEP 3

Pull down gently, whilst slightly rotating. Disconnect the cables.

NOTE: When rotating the fixture choose the direction with the least resistance.

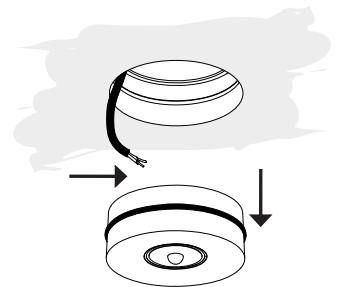

TO REMOVE OR CHANGE MOTION KIT

STEP 1

Use a screwdriver or similar object to gently prise the taps on the retaining disk out from under the ridge on the fixture.

