

## STORM SYSTEM®

The Storm Small Output is part of the STORM SYSTEM® SMALL collection. A collection that includes a wide range of special designed products. The STORM SYSTEM® collection is carefully designed to flush the surface of any ceiling or wall, and all products will appear with an absolute minimum of tolerance and visibility.

The Storm Small Output is designed to hide the canopy of your pendants. Visually the wire disappears into the ceiling.

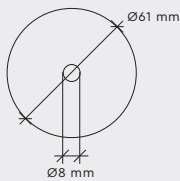
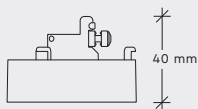

# STORM SMALL OUTPUT

## DATA

Collection	STORM SYSTEM®
Product	Storm Small Output
Article no.	1A00.0500.xx

## SPECIFICATIONS

Weight	146 g
Material	Aluminium
IP protection grade	IP20
Labelling	CE
Load	See installation ring's datasheet
Fixture finish	For xx-codes review STORM SYSTEM® – COLOUR CODES ➤

## NOTE

By installation of pendants it is important to be aware of pendants load/weight. If your pendant exceeds the specified load – an additional anchor must be competed!

Please refer to the installation ring's datasheet.

Pendant cord must be a min. of Ø5 and max. of Ø8

Storm Small Output can be installed in sloped ceilings with an angle of up to 45°

## INSTALLATION DEPTH

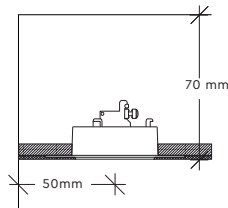

## IMPORTANT INFORMATION

Installation and mounting must be performed by a certified electrician only, and instructions must be followed

Always make sure the main power is off during installation. Pay attention to the fixture remarks, and always make sure to use the correct voltage.

## CLEANING AND MAINTENANCE:

Use a soft moist cloth for cleaning. No further maintenance is required.

## WARRANTY:

If the product is defect, please contact your supplier immediately. Please note that warranty will not apply in case of wrongful use or if unskilled personnel attempts to repair.

## COMPONENTS

- Storm Small Output



# STORM SMALL OUTPUT

## ASSEMBLY INSTRUCTION

### STEP 1

Adjust the length of the cord, leaving the fixture at the desired height. Fasten the cord properly, and test that the load of the chosen fixture is held in place.

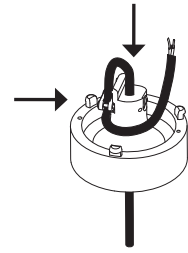

### NOTE

If the pendant has steel wire suspension, use the small hole for the steel wire and fasten with the small metal screw.

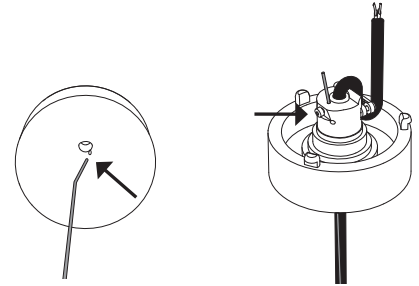

### STEP 2

Connect the cables.

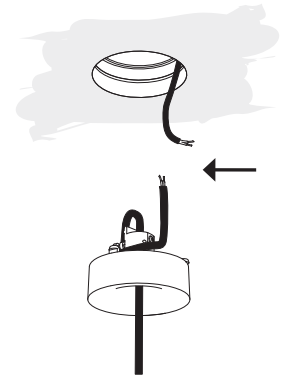

### STEP 3

Mount the fixture into the plaster ring/back-mounted ring. Do this by slightly rotating the fixture until it unlocks.

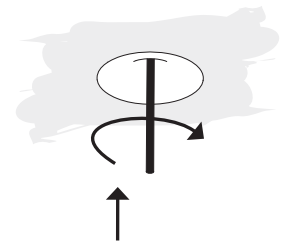

### STEP 4

Please ensure that the fixture aligns with the ceiling.

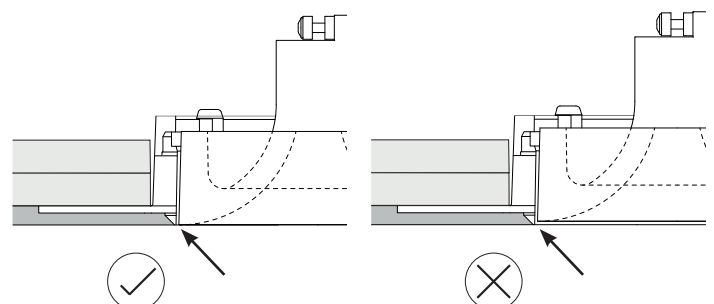

#### IMPORTANT INFORMATION

Disassembly must be performed by a certified electrician only, and instructions must be followed.

#### WARRANTY:

If the product is defect, please contact your supplier immediately. Please note that warranty will not apply in case of wrongful use or if unskilled personnel attempts to repair.

## STORM SMALL OUTPUT

### DISASSEMBLY INSTRUCTION

#### STEP 1

Push the fixture up and rotate slightly, then gently pull down.

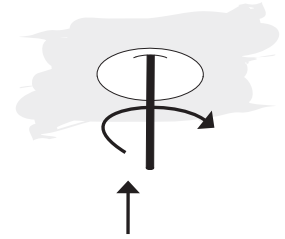

#### STEP 2

Disconnect the cables.

